



Specifications

Input Voltage :	24V AC/DC
Operating Temperature	0°C to 70°C
Luminaire	PCB Mounted LED's
LED Power dissipation	72mW
CRI	82 Typical
LED Color	Red / Amber / Green
Functions	Steady / Flashing / Buzzer
Protection grade	IP 54
Aluminium Stem	50 mm
Flasher	IC 555 & TIP 127 Transistor
LED operating current	20 mA
Buzzer Current	100 mA
Buzzer Sound	<100 db
Diameter	∅ 60 mm
Average Life Hours	30000 Hrs
Luminous Intensity	Red : 900-1200 mcd Amber : 400-900 mcd Green : 2000-2200 mcd

Ordering Codes

With Buzzer Models

SMC-M-1-T-1- (R/A/G)-(B/F/O) 24V AC/DC

Without Buzzer Models

SMC-M-1-T-1- (R/A/G)-(F/O) 24V AC/DC

Features

- Lamp for machine status Indication
- Suitable for machines and equipments in high light output LED's
- CE certified
- ROHS Compliant
- IP 54 grade Protection
- 3 Colors in 1 Lamp (Red, Amber & Green)
- Heat Resistant, shock proof & easily mountable
- Stringently checked on various criterion of performance
- Modular design with superior finishing & tamperproof packaging
- Longer functional life

Dimensional Drawing

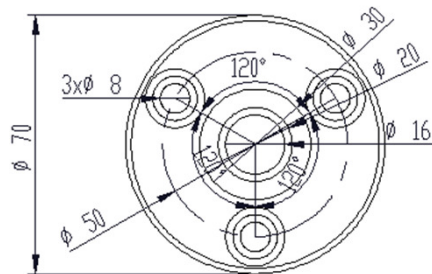

BOTTOM VIEW
MOUNTING DETAILS

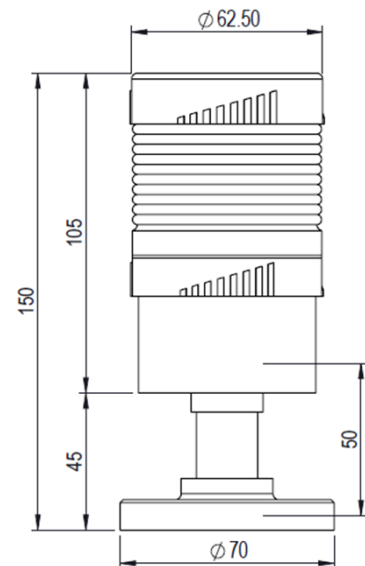

Wiring Diagram

