



Specifications

Input Voltage :	12V -24V AC/DC – 110V/230VAC						
Operating Temperature	0°C to 70°C						
Luminaire	PCB Mounted LED's						
LED Power dissipation	72mW						
CRI	82 Typical						
LED Color	Red / Amber / Green / Blue / Clear						
Functions	Steady / Flashing / Buzzer						
Foldable	180 degree						
Protection grade	IP 54						
Aluminium Stem	50 mm						
Flasher	IC 555 & TIP 127 Transistor						
LED operating current	20 mA						
Buzzer Current	100 mA						
Buzzer Sound	72 db @ 1 meter distance						
Diameter	∅ 60 mm						
Average Life Hours	30000 Hrs						
Luminous Intensity	<table border="0"> <tr> <td>Red : 900-1200 mcd</td> <td>Amber : 400-900 mcd</td> </tr> <tr> <td>Green : 2000-2200 mcd</td> <td>Blue : 200-500 mcd</td> </tr> <tr> <td>Clear : 800-1100 mcd</td> <td></td> </tr> </table>	Red : 900-1200 mcd	Amber : 400-900 mcd	Green : 2000-2200 mcd	Blue : 200-500 mcd	Clear : 800-1100 mcd	
Red : 900-1200 mcd	Amber : 400-900 mcd						
Green : 2000-2200 mcd	Blue : 200-500 mcd						
Clear : 800-1100 mcd							

Ordering Codes

With Buzzer Models

SMC-F-3-T-1- (R/A/G/B/C)-(B/F/O)	24V AC/DC
SMC-F-3-T-2- (R/A/G/B/C)-(B/F/O)	110 VAC
SMC-F-3-T-3- (R/A/G/B/C)-(B/F/O)	230 VAC

Without Buzzer Models

SMC-F-3-T-1- (R/A/G/B/C)-(F/O)	24V AC/DC
SMC-F-3-T-2- (R/A/G/B/C)-(F/O)	110 VAC
SMC-F-3-T-3- (R/A/G/B/C)-(F/O)	230 VAC

Features

- Lamp for machine status Indication
- Suitable for machines and equipments in high light output LED's
- CE certified
- ROHS Compliant
- IP 54 grade Protection
- 180 degree Foldable
- Heat Resistant, shock proof & easily mountable
- Stringently checked on various criterion of performance
- Modular design with superior finishing & tamperproof packaging
- Longer functional life

Dimensional Drawing

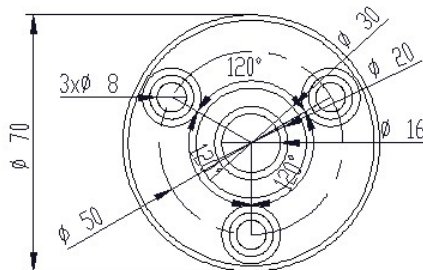

BOTTOM VIEW
MOUNTING DETAILS

Wiring Diagram

