



Specifications

Input Voltage	24V DC
Wattage	3W
IP Rating	IP54
Operating Temp	0 to 70 degree Celsius
LED	SMD Tricolor LED 5050
LED Colors	Red / Amber / Green
Dome	Polycarbonate
Base	Nylon-Glass filled-15%-Black
Mounting Base	ABS
Mounting Fastners	M6 Screws
Avg. Life Hours	20,000 Hrs

Ordering Code

Model	Input Voltage	Dimensions
SMC-M-1-T-1-RAG-O	24VDC	215 X 83

Features

- PC Lens, hard to distort or Crack
- Bright, glare free illumination with soft light
- Energy Saver with IP 54 Grade Protection
- Ideal for temperature fluctuating situations
- Stringently checked on various criterion of performance
- Modular design with Superior Finishing & tamperproof packaging
- Heat resistant & shock proof & easily mountable
- Sturdy construction with good electric shock resistance
- Low Power Consumption & energy Saving
- Longer functional life

Dimensional Drawing

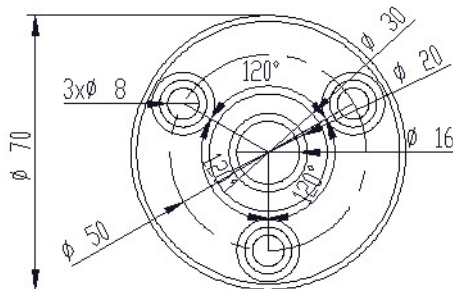

BOTTOM VIEW
MOUNTING DETAILS

